

spirax sarco

Stainless Steel Strainers TSSY

Type	TSSY
Sizes	1/2", 3/4", 1", 1-1/4", 1-1/2", 2"
Connections	NPT or SW to ANSI B16.11
Construction	Investment Cast Stainless Steel Type 316L
**Max Saturated Steam Pressure	300 PSI @ 420°F
*Screen	1/32" perf. (.031)

*Note: 28% open area
** See Fig16 HP, TI-P169-08 ASME Class 800 Strainer for higher pressures

Pressure Temperature Ratings

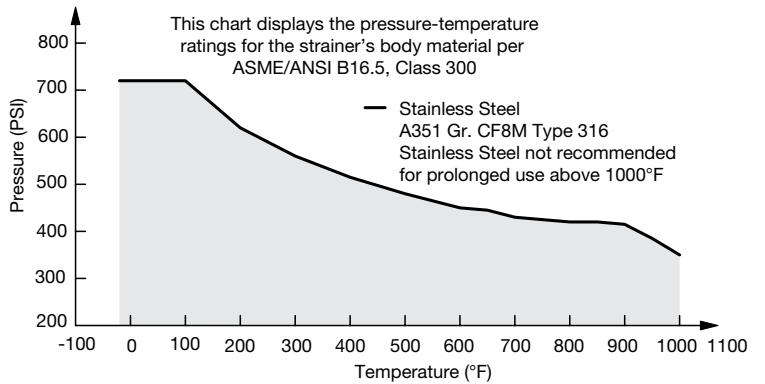

C_v Values

Size	C _v
1/2"	9.4
3/4"	18.0
1"	30.0
1-1/4"	45.0
1-1/2"	63.0
2"	98.0

Pressure/Temperature Rating¹

SS - ASTM A351 GR. CF8M

WOG (Non-shock): 720 PSI @ 100 °F

Saturated Steam: 300 PSI @ 420 °F

Maximum Liquid: 350 PSI @ 1000 °F

¹ The above listed temperatures are theoretical and may vary during actual operating conditions.

For water:

$$\text{Pressure Drop} = \frac{(\text{GPM})^2}{(\text{Cv})^2}$$

Consult factory for other liquids.

See TI-7-429 for pressure drops on steam, air and other gases.

Bill of Materials¹

No.	Part	Material
1	Body	ASTM A351 GR: CF8M Type 316
2	Bonnet	ASTM A351 Gr. CF8M Type 316
3	Screen ²	Stainless Steel
4	Gasket	PTFE
5	NPT Plug	Stainless Steel

¹ Bill of Materials represents standard materials. Equivalent or better materials may be substituted at the manufacturer's discretion.

² Denotes recommended spare parts.

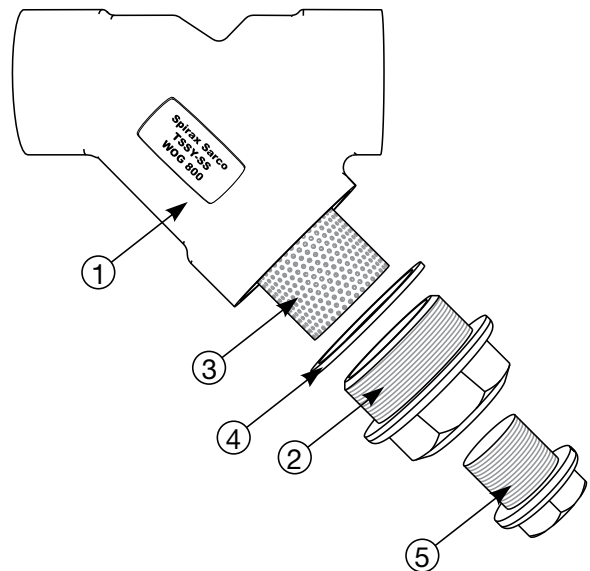

Stainless Steel Strainers TSSY

Dimensions							
Size	in	1/2	3/4	1	1 1/4	1 1/2	2
	mm	15	20	25	32	40	50
A DIMENSION FACE TO FACE (NPT) (2)	in	2.55	3.14	3.54	4.13	4.72	5.5
	mm	65	80	90	105	120	140
A DIMENSION FACE TO FACE (SW) (2)	in	2.55	3.14	3.54	4.13	4.72	5.51
	mm	65	80	90	105	120	140
B DIMENSION CENTER LINE TO BOTTOM (NPT)	in	2.00	2.36	2.83	3.03	3.42	4.06
	mm	51	60	72	77	87	103
B DIMENSION CENTER LINE TO BOTTOM (SW)	in	2.00	2.36	2.83	3.03	3.42	4.05
	mm	51	60	72	77	87	103
C DIMENSION SCREEN REMOVAL	in	2.50	3.25	3.75	4.25	4.75	5.50
	mm	64	83	95	108	120	140
D DIMENSION NPT PLUG (BLOW OFF)	in	1/4	3/8	3/8	3/4	3/4	1
	mm	8	10	10	20	20	25
APPROXIMATE ASSEMBLED WEIGHT	lb	0.5	1.0	1.5	2.0	2.5	4.0
	kg	0.2	0.5	0.7	0.9	1.1	1.8

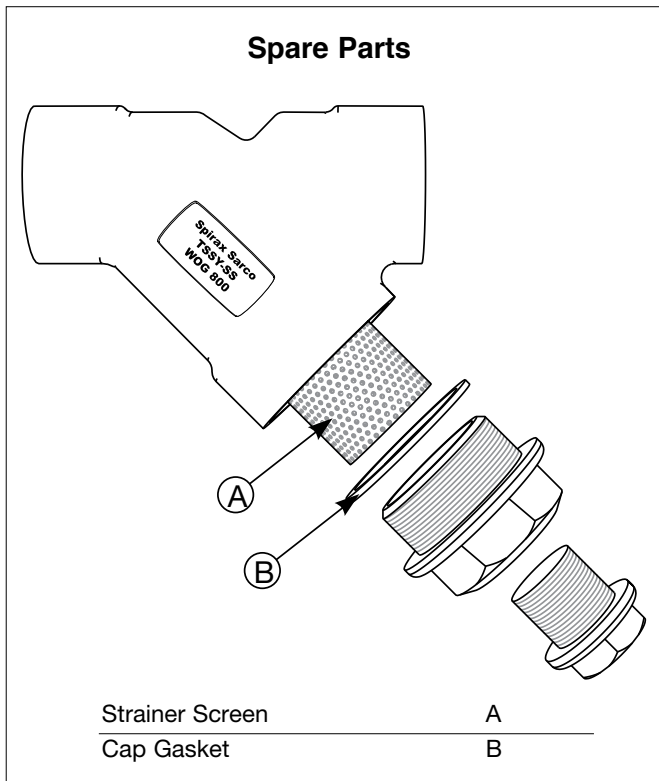
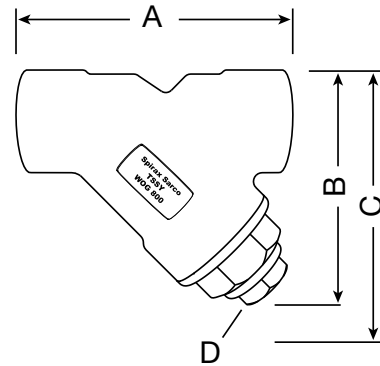

Installation

The strainer should be installed with the flow direction as indicated on the body, in a vertical down or horizontal pipeline. The strainer must be accessible for periodic removal of accumulated debris, by either blowing down or removal and cleaning of the screen.

TI-7-406-US 8.19