

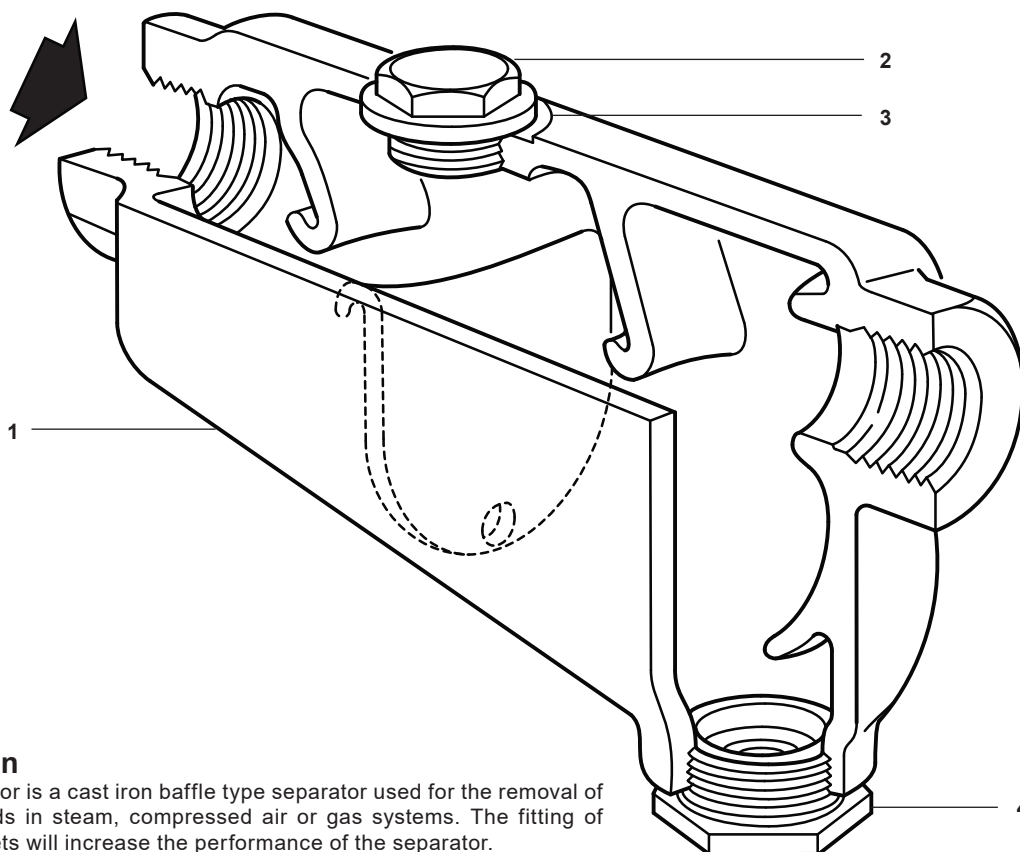

S2 Cast Iron Separator (Screwed)



Description

The S2 separator is a cast iron baffle type separator used for the removal of entrained liquids in steam, compressed air or gas systems. The fitting of insulation jackets will increase the performance of the separator.

Standards

This product fully complies with the requirements of the Pressure Equipment Directive (PED).

Certification

This product is available with a manufacturers' Typical Test Report.

Note: All certification/inspection requirements must be stated at the time of order placement.

Sizes and pipe connections

1/4", 1/2" and 2" screwed BSP or NPT.

Materials

No.	Part	Material	
1	Body	Cast iron	ASTM A126 CI B
2	Plug (2" only)	SG iron	DIN 1693 GGG 40
3	Gasket (2" only)	Reinforced exfoliated graphite	
4	Drain reducing bush	Steel	ASTM A105

Pressure/temperature limits (ISO 6552)

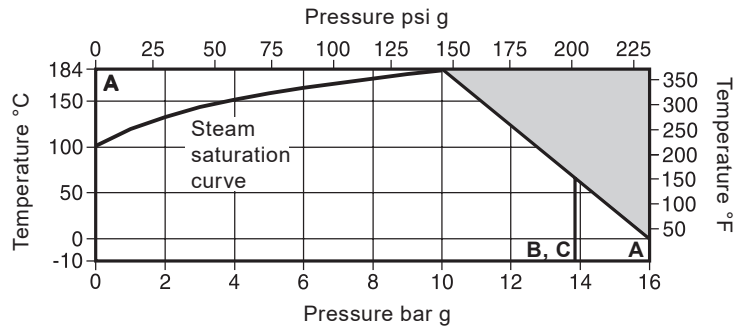

The product **must not** be used in this region.

A - A Flanged EN 1092 PN16, Table F and screwed BSP or NPT.

A - B Flanged JIS/KS 10K.

A - C Flanged ASME Class 125.

Body design conditions		PN16	
PMA	Maximum allowable pressure	16 bar g @ 0 °C	(232 psi g @ 32 °F)
TMA	Maximum allowable temperature	184 °C @ 10 bar g	(363 °F @ 145 psi g)
	Minimum allowable temperature	-10 °C	(14 °F)
PMO	Maximum operating pressure for saturated steam service	10 bar g	(145 psi g)
TMO	Maximum operating temperature	184 °C @ 10 bar g	(363 °F @ 145 psi g)
	Minimum operating temperature	-10 °C	(14 °F)
	Note: For lower operating temperatures consult Spirax Sarco.		
	Designed for a maximum cold hydraulic test pressure of:	24 bar g	(348 psi g)

Note: Flanged separators (S3) may be supplied with a lower pressure rating than that cast into the body. Reference should be made to the appropriate operating chart to determine the actual product limitations.



Dimensions, weights and volumes (approximate)

	Size	A	B	C	D	E	F	G	Weight	Volume
mm, kg and litres	1¼"	111	156	89	304	12.7	38.1	60	9.6	1.5
	1½"									
	2"	166	205	117	397	12.7	38.1	71	19.0	3.2

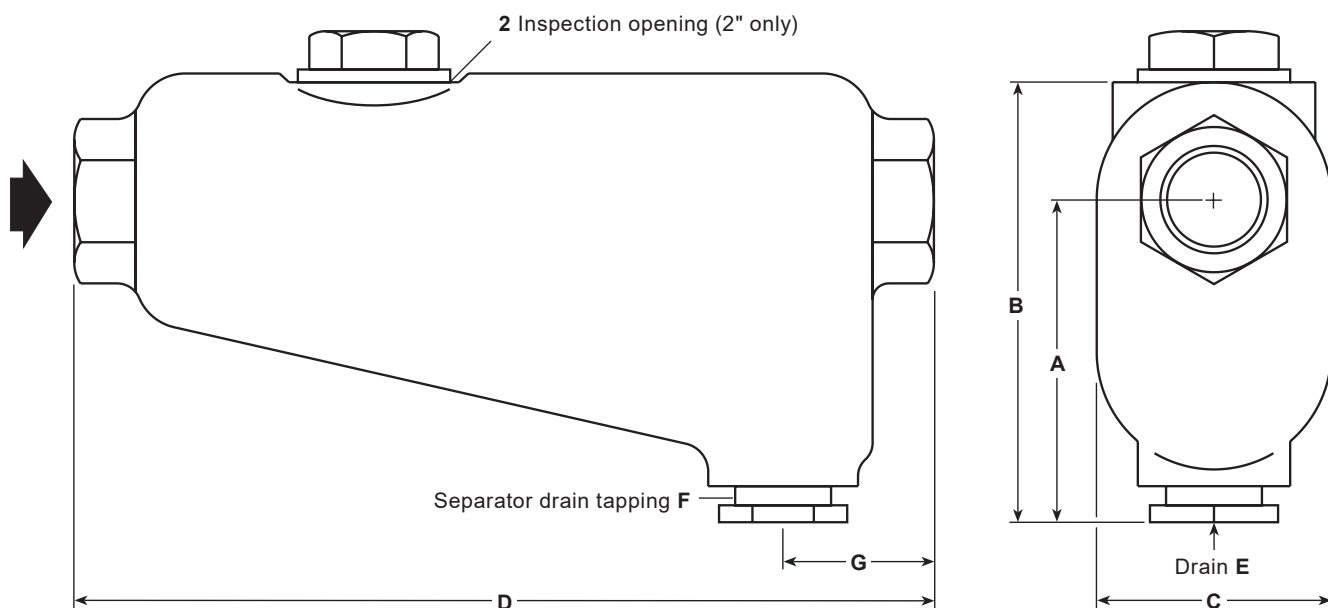
	Size	A	B	C	D	E	F	G	Weight	Volume
inches, lbs and gallons	1¼"	4.37	6.14	3.5	11.9	½"	1½"	2.36	21.1	0.32
	1½"									
	2"	6.53	8.07	4.60	15.6	½"	1½"	2.79	41.8	0.70



Recommended tightening torques

Item	Size	 or 	mm	N m	(lbf ft)
2	2"	60 A/F	M72	190 - 210	(140 - 155)

Safety information, installation and maintenance

For full details see the Installation and Maintenance Instructions (IM-P023-55) supplied with the product.

Installation note:

Install in a horizontal pipeline with the drain directly below.

Note: To ensure that any separated liquid is drained away quickly, a suitable liquid drainer or steam trap must be connected to the drain connection 'E' - consult Spirax Sarco for further details.

Disposal

This product is recyclable. No ecological hazard is anticipated with the disposal of this product, providing due care is taken.

How to order

Example: 1 off 2" Spirax Sarco S2 separator with cast iron body having screwed BSP connections.