

spirax/sarco

'C' Series Valve Spares

Spare parts

The spare parts available for the CE43, CE63 and CE83 valves, 1" to 8" (DN25 to DN200), are detailed below. No other parts are supplied as spares.

Available spares

Actuator clamping nut	A	
Gland seal kit	PTFE seal set	B
	Graphite packing set	C
Valve plug	D	
Valve stem	E	
Valve gasket kit	Graphite gasket	F1
	Bonnet Spacer	F2
	Spiral wound gasket	F3
	Seat	F4
Piston seal kit	Adaptor gasket	F5
	Graphite	G
	PTFE	H
Valve seat	I	
Valve cage	J	
Reduction kit (seat, cage and reduction adaptor)	K	

Note: A 'valve gasket kit' should be ordered with the above items.

'C' Series valve

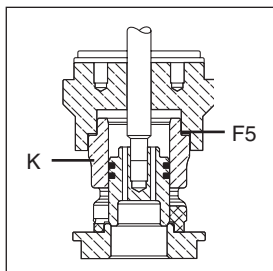
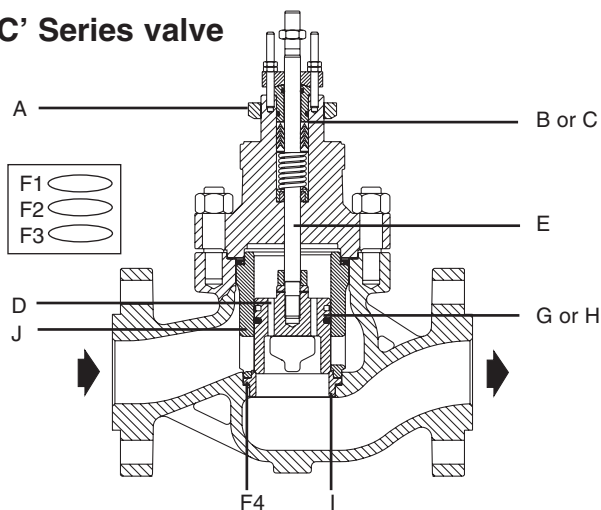

How to order example

1 - Valve seat and valve gasket kit for a 2" CE43PTC1US1 Cv35 valve, flanged to ANSI 300, serial number FR00001. Date coded M00.

How to fit spares

Full instructions are given in the Installation and Maintenance Instructions supplied with the spare.

Note:

When placing an order for spares please indicate clearly the model number, serial number and date code (found on the label of the valve body) to ensure that the order is processed quickly, efficiently and correctly.

How to order spares

Always order spares by using the description given in the column headed 'Available spares'. Also state the information shown in the 'C' series valve selection guide, the serial number, and date code of the valve.

'C' series valve selection guide

Valve size	1", 1-1/2", 2", 2-1/2", 3", 4", 5", 6", and 8" DN25, 40, 50, 65, 80, 100, 125, 150 and 200	<input type="text" value="2"/>
Valve series	C = Cage trim	<input type="text" value="C"/>
Valve characteristic	L = Linear	<input type="text" value="E"/>
	E = Equal percentage	
	F = Fast opening	
	M = Modified equal percentage	
Body material	4 = Carbon steel	<input type="text" value="4"/>
	6 = Stainless steel	
	8 = Alloy steel	
Connections	2 = Butt weld (2" to 8")	<input type="text" value="3"/>
	3 = Flanged	
	4 = Socket weld (1", 1-1/2" and 2")	
Stem sealing options	P = PTFE chevron	<input type="text" value="P"/>
	H = Graphite	
	B = Bellows	
Seating options	T = AISI 431 hardened	<input type="text" value="T"/>
	G = PTFE soft seat	
	W = Hard stellite AISI 316	
Type of trim cage	C = Standard cage	<input type="text" value="C"/>
	P = Noise reducing perforated	
	A = Anti-cavitation cage	
Number of stages	1 = One	<input type="text" value="1"/>
	2 = Two	
	3 = Three	
	Other = To be specified	
Trim balancing	B = Balanced	<input type="text" value="U"/>
	U = Unbalanced	
Bonnet type	S = Standard	<input type="text" value="S"/>
	H = Extended for high temperature	
	L = Extended for low temperature	
Reduced trim	0 = No reduction	<input type="text" value="1"/>
	1 = 1 reduction	
	2 = 2 reductions	
	3 = 3 reductions	
Cv	To be specified	<input type="text" value="Cv 35"/>
Connection type	To be specified	<input type="text" value="ANSI 300"/>
<input type="text" value="2"/> <input type="text" value="C"/> <input type="text" value="E"/> <input type="text" value="4"/> <input type="text" value="3"/> <input type="text" value="P"/> <input type="text" value="T"/> <input type="text" value="C"/> <input type="text" value="1"/> <input type="text" value="U"/> <input type="text" value="S"/> <input type="text" value="1"/> <input type="text" value="Cv 35"/> <input type="text" value="ANSI 300"/>		<input type="text" value="ANSI 300"/>

Local regulation may restrict the use of this product below the conditions quoted. Limiting conditions refer to standard connections only. In the interests of development and improvement of the product, we reserve the right to change the specification.

TI-F12-22-US 6.07

Control Valves

Globe Control Valves