

Gilflo Flowmeters - 'B' Pipeline Unit

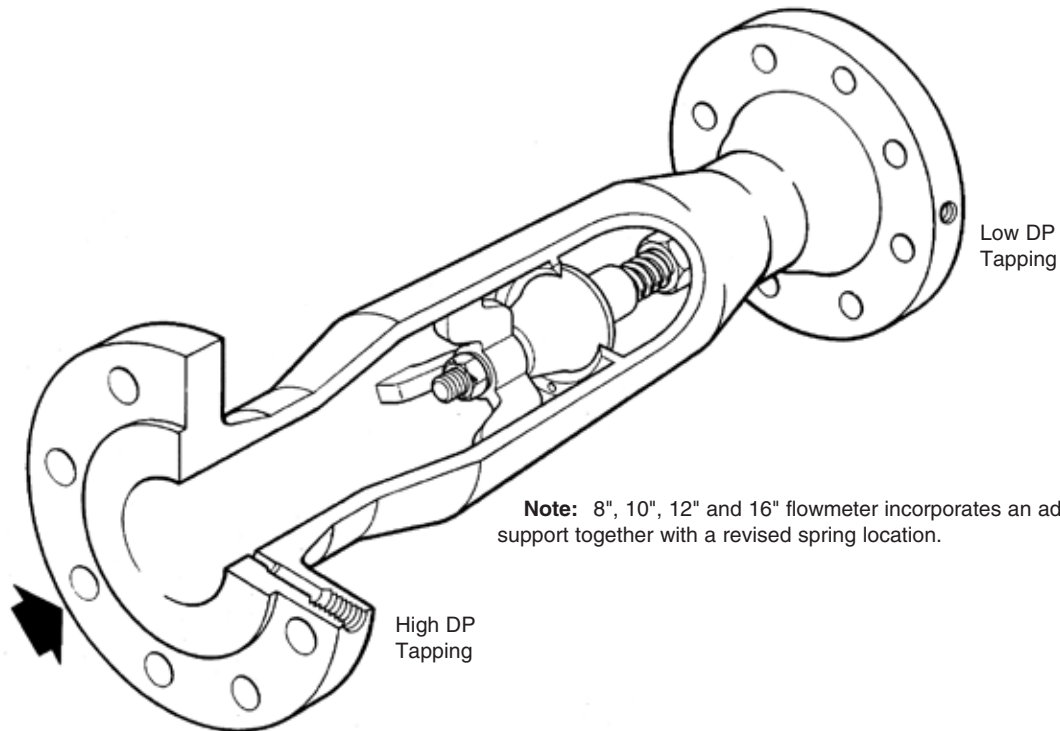

Description

The Gilflo 'B' flowmeter is installed in the pipeline and produces a differential pressure which is related to the rate of flow. It can be used with most industrial fluids, gases and both saturated and superheated steam.

Sizes and Pipe Connections

2", 3", 4", 6", 8", 10", 12" and 16"
Flanges available to ANSI B.16.5 class 300

Limiting Conditions

Minimum operating pressure	9 psig
Maximum operating pressure	740 psig
Minimum operating temperature	-58°F
Maximum operating temperature	842°F
Maximum viscosity	30 centipoise

Turndown

The Gilflo will provide accurate measurement over a flow range of 100:1.

Accuracy

To achieve accuracy of a $\pm 1\%$ of reading, all Gilflo meters must be used in conjunction with a device capable of performing electronic linearism such as:

- M750 Flow Computer
- Customer's EMS, DCS or equivalent
- M800 Steam Flow Computer
- M800 Gas Flow Computer

Note: When used with M800 flow computers, Gilflo accuracy is $\pm 1\%$ of reading from 5% to 100% of maximum rated flow. For flows from 1% to 5% of maximum rated flow, accuracy will be better than $\pm 1\%$ FSD.

Repeatability

The Gilflo is repeatable to better than 0.25%.

Pressure Drop

Less than 140 inches H₂O (349 mbar) at rated capacity

Flow Capacity

To determine the maximum flow capacity of a Gilflo 'B', it is necessary to calculate the equivalent water flowrate (Q_w). See under the section "Sizing the Gilflo 'B' flowmeter".

Materials of Construction

Body	Carbon Steel	ASTM A105/A106/A234
Internals	Mostly Stainless Steel	S304/S316
Spring	Inconel X750	