

spirax/sarco®

Spare Parts Guide

2-1/2" to 4" 25P, 25PE, 25PT, 25PTE, 25PA, 25BP, Main Valves

Spare Parts – Main Valve

Cover Assembly w/ Cap Screws & Gasket	A,B, C
Diaphragm Case Bolts & Nuts	G,H
Screen, Spring Support Disc, Valve Spring & Cap Gasket	M, N, O, C
*Cap Gasket, Valve Head, Seat & Seat Gasket (2)	C, P, Q, R
specify regular or reduced port "S" valve	
Valve Stem Guide	J, S, T
Diaphragm Plate	K
Diaphragms (2 ply)	L
*Transmission Tubing w/ Assembly	U, V
* Gasket Kit	C, R, S, W

How to Order

Always order spares by using the description given in the first column under Spare Parts, stating the valve size and material. Example: 1 – Cover Assembly for 1-1/2" Spirax Sarco 25P Cast Iron Reducing Valve.

Maintenance

See installation and maintenance instructions supplied with each valve, copies are available on request.

Spares Kit

* A standby set of spares for general maintenance purposes includes all spares marked.

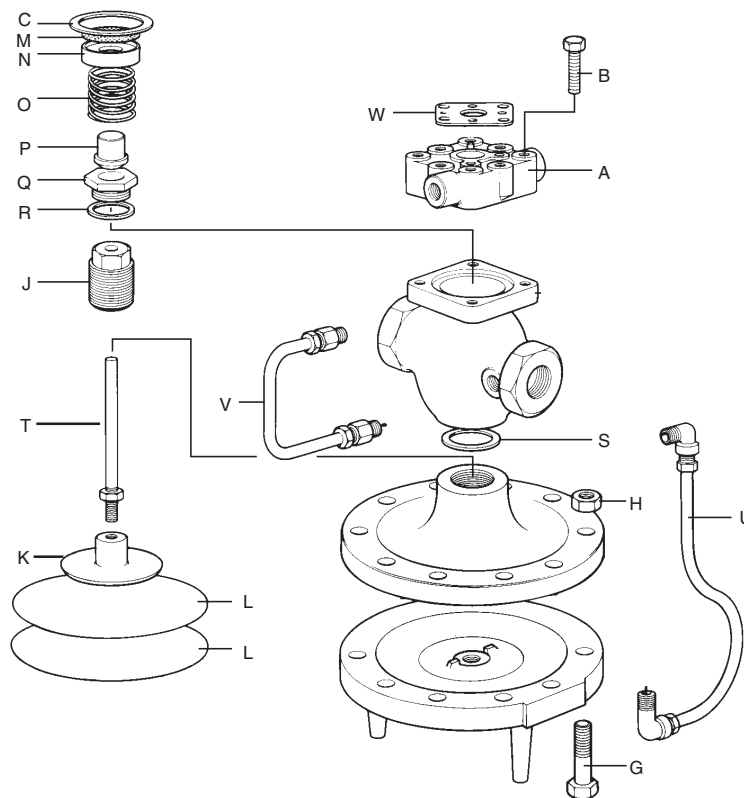

Local regulation may restrict the use of this product below the conditions quoted. Limiting conditions refer to standard connections only.
In the interests of development and improvement of the product, we reserve the right to change the specification.

TI-3-027-US 06.10

Spare Parts Guide

2-1/2" to 4" 25P, 25PE, 25PT, 25PTE, 25PA, 25BP, Main Valves

Spare Parts – Main Valve

Cover Assembly w/ Cap Screws & Gasket A,B, C	
Diaphragm Case Bolts & Nuts	G,H
Screen, Spring Support Disc, Valve Spring & Cap Gasket	M, N, O, C
*Cap Gasket, Valve Head, Seat & Seat Gasket (2)	C, P, Q, X
Diaphragms (2 ply)	L
*Transmission Tubing w/ Assembly	U
* Gasket Kit	S, W, C
Damping Assembly	A1, B1, C1
Diaphragm Plate	K
Lower Stem & Guide	J, T
Relief Tube	D1

How to Order

Always order spares by using the description given in the first column under Spare Parts, stating the valve size and material. When ordering temperature pilots, specify the bulb style, capillary length and temperature range.

Example: 1 – Cover Assembly for 2-1/2" Spirax Sarco 25P Cast Iron Reducing Valve

Maintenance

See installation and maintenance instructions supplied with each valve, copies are available on request.

Spares Kit

* A standby set of spares for general maintenance purposes includes all spares marked.

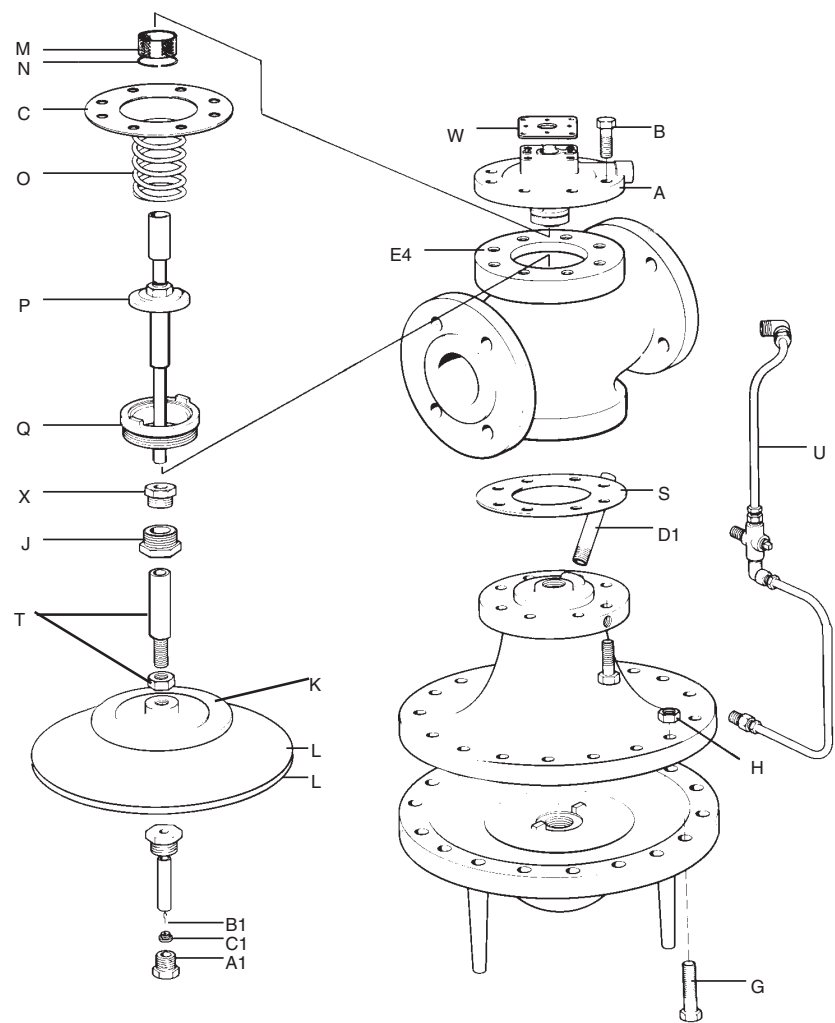

© Spirax Sarco, Inc. 2010

TI-3-027-US 06.10