

spirax sarco®

Spare Parts Guide 6" 25T, 25TE, 25E, Main Valve

SPARE PARTS – MAIN VALVE

Main Valve Spring & Lower Diaphragm Cover Gaskets	O, S
Diaphragm Plate & Set Screws	K, D
Transmission Tubing with Fittings	U
Diaphragms (2 per set)	L
Gasket Kit	C, S, W
Head, Stem & Seat Assembly (specify regular or reduced part "S" valve)	P, Q, C
Screen Assembly	I, J
Cover Bolt Kit	B
Diaphragm Case Bolt Kit	G, H
Rebuild Kit	BCLOPQSUW
Pilot Platform:	X

HOW TO ORDER

Always order spares by using the description given in the first column under Spare Parts, stating the valve size and material.

Example: 1 – Diaphragm Plate & Set Screws for 6" Spirax Sarco 25T Cast Iron Reducing Valve

MAINTENANCE

See installation and maintenance instructions supplied with each valve, copies are available on request.

Main valve seat in 6" regulator is field replaceable. Please consult factory for seat removal tool. To retain tight shut off, minor wear can be corrected by lapping with suitable grinding compound.

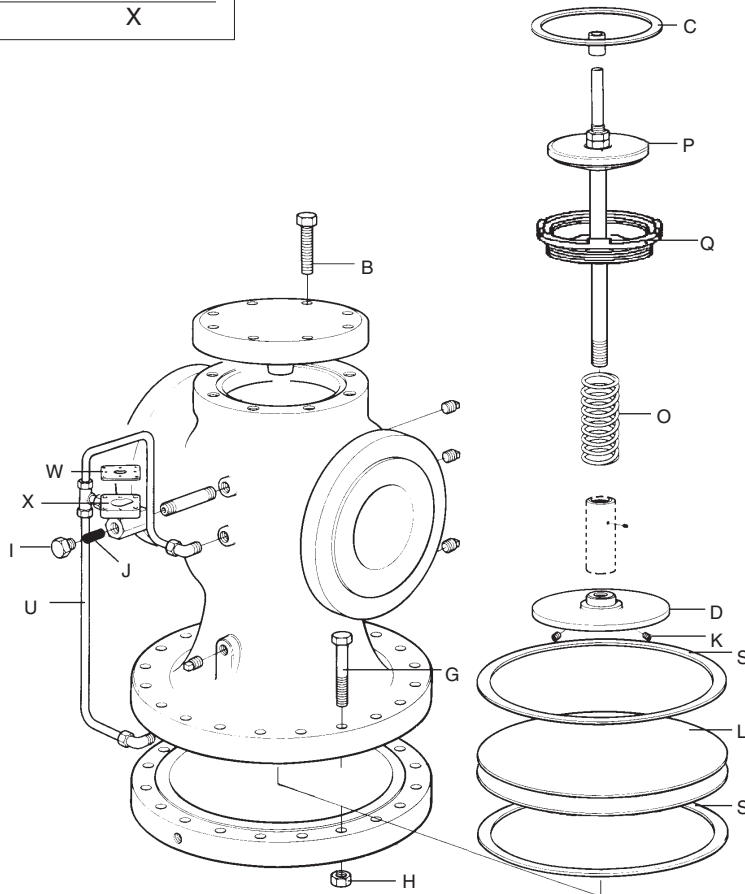

Spare Parts Guide

1/2" to 6" 25T, 25TE, 25E Pilots

SPARE PARTS - TEMPERATURE & ELECTRIC PILOT

Thermal System (T1, T2, T3, T10, T11, T12) State bulb style, capillary tube length and temperature range	A2
Well (T5, T6, T7, T8, T11) (Specify bulb style)	B2
Wall Mounting Bracket (T9) (Specify bulb style)	C2
Complete Pilot Body Assembly	D2, W
Head & Seat Assembly Specify 15 psig or below Assembly or Standard	E2, W
Electric Pilot	
NEMA 4&7 Solenoid (specify voltage & steam pressure)	C3
Complete "E" Pilot Body Assembly	B3

HOW TO ORDER

Always order spares by using the description given in the column headed Spare Parts, stating the valve size and material. When ordering Temperature Pilots, specify the bulb style, capillary length and temperature range. When ordering electric pilots, specify electrical characteristics, size of main valve.

Example 1 – Thermal System style T1 for 1" Spirax Sarco 25T temperature regulator with 8-ft. capillary tubing and temperature range 120°F to 180°F.

Example 2 – Head & Seat Assembly for 1/2" Spirax Sarco 25TE temperature regulator with a NEMA 4 115volt, 60 Hz AC solenoid steam pressure 200 psi.

MAINTENANCE

For complete installation & maintenance instructions, see the IMI sheet, which accompanies the product.

