



Cert. No. LRQ 0963008

ISO 9001

spirax sarco

UFT32

TI-P146-05
ST Issue 4

Sealed Stainless Steel

Ball Float Steam Trap (for use with Pipeline Connectors)

Description

The UFT32 is an austenitic stainless steel maintenance free sealed ball float steam trap with an integral automatic air venting facility. It is designed for differential steam pressures up to 32 bar. When installed with a suitable pipeline connector the UFT32 can easily and simply be removed without breaking into the pipeline, thus speeding up trap replacement with minimal system downtime. Pipeline connectors are available with screwed, socket weld and flanged end connections.

Capsule

The BP99/32 capsule which is used in the UFT32 is suitable for use on 150°C superheat @ 0 bar g and 50°C superheat @ 32 bar g.

UFT32 fitted to a PC3_ connector

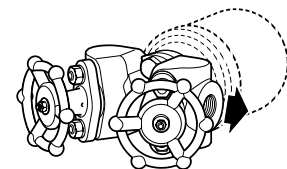
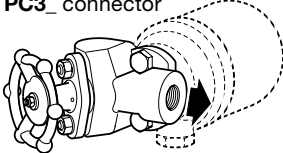

UFT32 fitted to a PC4_ connector

Standards

The body to cover welded joint complies with ASME Section IX and BS/EN 288.

This product fully complies with the requirements of the European Pressure Equipment Directive 97/23/EC.

Certification

This product is available with certification to EN 10204 3.1. **Note:** All certification/inspection requirements must be stated at the time of order placement.

Pressure/temperature limits (ISO 6552)

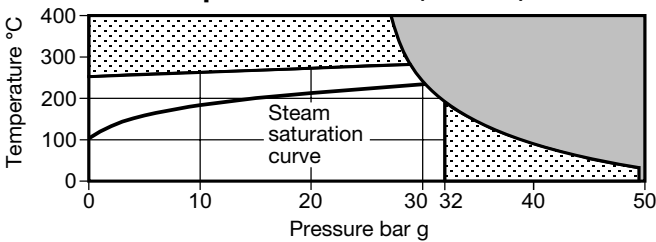

The product **must not** be used in this region.

The product should not be used in this region or beyond its operating range as damage to the internals may occur.

Note: The model of pipeline connector and connections selected will dictate the maximum operating limits of the complete assembly. Reference the specific pipeline connector Technical Information sheet as detailed in 'Pipeline connector options'.

Body design conditions PN50 (ASME / ANSI 300)

PMA Maximum allowable pressure 50 bar g @ 38°C

TMA Maximum allowable temperature 400°C @ 28 bar g

Minimum allowable temperature -48°C

PMO Maximum operating pressure for saturated steam service 32 bar g

TMO Maximum operating temperature 286°C @ 29 bar g

Minimum operating temperature 0°C

Note: For lower operating temperatures consult Spirax Sarco

	4.5 bar	UFT32-4.5
	10 bar	UFT32-10
ΔPMX	14 bar	UFT32-14
	21 bar	UFT32-21
	32 bar	UFT32-32

Designed for a maximum cold hydraulic test pressure of 50 bar g

Pipeline connector options

The UFT32 can be fitted to a variety of pipeline connectors:

PC10	Straight connector	ASME/ANSI 300	(TI-P128-10)
PC10HP	Straight connector	ASME/ANSI 600	(TI-P128-10)
PC20	Connector with Y-type strainer	ASME/ANSI 300	(TI-P128-15)
IPC21	Connector with Y-type strainer and integral Spiratec sensor	ASME/ANSI 300	(TI-P128-17)
PC3_	Connector with one piston isolation valve	ASME/ANSI 600	(TI-P128-02)
PC4_	Connector with two piston isolation valves	ASME/ANSI 600	(TI-P128-03)
STS17	Steam trap station		(TI-P178-01)

See the relevant Technical Information sheet as listed above for details of the connections available for each pipeline connector.

UFT32

fitted to a PC10 connector

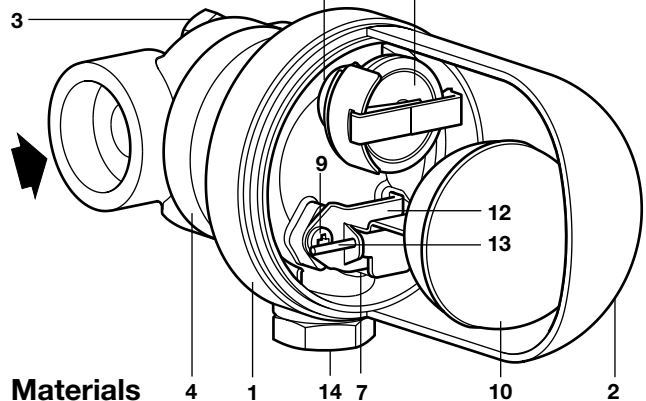

Materials

No.	Part	Material
1	Body	Austenitic stainless steel 304 EN 10213-4 1.4308; ASTM A351 CF8
2	Cover	Austenitic stainless steel 304 EN 10028-7 1.4301; ASTM A240 Gr. 304
3	Connector screws	Steel ASTM A193 B7
4	Flange	Alloy steel A322 Gr. 4130
* 5	Inlet gasket	Graphite / Stainless steel laminate AISI 316 strip
* 6	Outlet gasket	Graphite / Stainless steel laminate AISI 316 strip
7	Main valve seat	Stainless steel BS 970 431 S29
8	Main valve/air vent seat gasket	Stainless steel BS 1449 304 S11
9	Main valve assembly screws	Stainless steel BS 6105 CI A2-70
10	Ball float and lever	Stainless steel BS 1449 304 S16
11	Air vent assembly	Stainless steel
12	Pivot frame	Stainless steel BS 1449 304 S16
13	Pivot pin	Stainless steel
14	Plug	Austenitic stainless steel 304 EN 10088-3 1.4301 ASTM A479 304

* **Note:** Items 5 and 6 are shown clearly in the spares drawing overleaf.

Dimensions / weight approximate in mm and kg

Size	A	B	C	Weight
UFT32	164	94	57	2.02

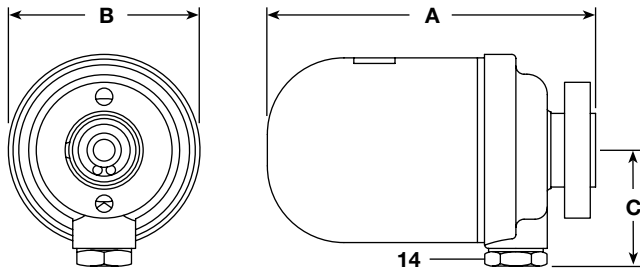

Safety information, installation and maintenance

For full details see the Installation and Maintenance Instructions (IM-P146-01) supplied with the product.

Installation note:

The UFT32 can be installed on any pipeline connector, but must be installed in a horizontal plane with the plug (14) downwards. See separate Installation and Maintenance Instructions for Spirax Sarco pipeline connectors (IM-P128-06, IM-P128-11 and IM-P128-13).

Disposal

The UFT32 trap unit is manufactured from stainless steel and is therefore totally recyclable. No ecological hazard is anticipated with the disposal of this product provided due care is taken.

How to specify

Steam traps shall be sealed ball float traps UFT32 type suitable for a differential operating pressure of either 4.5, 10, 14, 21 or 32 bar. Traps to be zero maintenance and be connected to a separate pipeline connector by two screws to allow for quick and simple installation/replacement.

For example Spirax Sarco UFT32-32 ball float steam trap.

How to order

The UFT32 is supplied as follows:-

	PC10	Standard connection
	PC20	One integral ISO valve plus 'Y' type strainer
1. The swivel pipeline connector	IPC21	One integral ISO valve plus 'Y' type strainer and Spiratec sensor
	PC3_	One integral ISO valve
	PC4_	Two integral ISO valves

2. The STS17 steam trap station

3. The UFT32 trap complete with inner and outer gaskets (securely crimped in place) and two connector screws. These items will be supplied in a protective box.

Note: Any optional extras need to be specified at the time of order placement.

How to order example:

1 off Spirax Sarco DN20 PC10HP pipeline connector with socket weld connections.

or

1 off DN20 STS17 steam trap station having socket weld connections.

and / or if you are ordering a replacement for an existing unit:



1 off Spirax Sarco UFT32-21 sealed stainless steel ball float steam trap.

plus

1 off Spirax Sarco insulating jacket to fit a UFT32.

Please note: The above items are to be supplied with connector screws and gaskets.

Recommended tightening torques

Item	Part	 or  mm	N m
3	Connector screws	5/16" A/F	30 - 35

Capacities (in accordance with ISO 7842)

Note: Capacities shown are based on discharge at saturation temperature. When discharging sub-cooled condensate the air vent provides extra capacity. Under start-up conditions the thermostatic air vent will be open, and will provide additional condensate capacity to the main valve assembly. This will provide a minimum of 100% increased capacity above the hot condensate figures shown.

For example: A UFT32-14 has a hot condensate capacity of 195 kg/h at 5 bar differential. The cold start-up capacity will be a minimum of 390 kg/h.

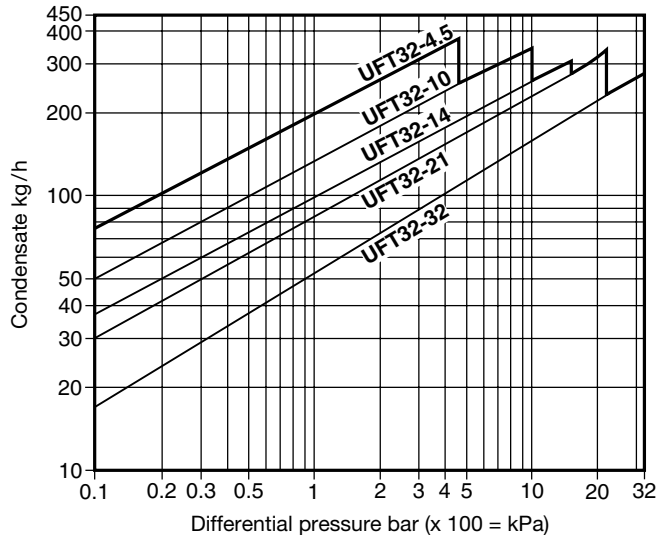

Spare parts

The UFT32 is a sealed non-maintainable trap unit. No internal spares are available.

The spares that are available are shown in solid outline. Parts shown in broken line are not available as spares.

Available spares

Connector screws (x 2) **3**

Complete **UFT32** trap unit inclusive of gaskets and connector screws (**3**)

How to order spares

Always order spare parts by using the description given in the column headed 'Available spares' and state the size, model no. and pressure rating of the trap.

Example: 2 x Connector screws for a Spirax Sarco UFT32 sealed stainless steel ball float steam trap (for use with pipeline connectors).

