



Cert. No. LRQ 0963008

ISO 9001

M60 스텐레스강 볼밸브(청정증기용)

● 개요

M60

가

● 구경 및 배관연결방법

" , ½" ¾", 1", 1¼", 1½", 2", 2½", 3", 4"
0.065"(16 gauge)O/D tube and Tri-clamp
가

● 내부마감

가 32 (0.81 µm) Ra

● 기술사양

Leakage Test procedure to ISO 5208 (rate 3)

Stem seal and seat Materials comply with FDA Code of Federal Regulations Title 21, Part 177.

● 운전조건범위

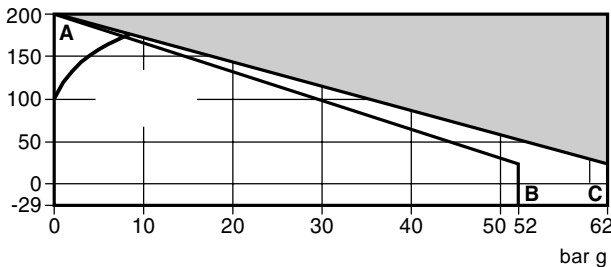

A - B Virgin PTFE seats
B - B Reinforced PTFE seats

몸체설계조건	PN63
최고허용압력(PMA) @ 20 °C	62 bar g
최고허용온도(TMA) @ 0 bar g	200 °C
최저허용온도	-29 °C
최고사용압력(PMO)	Virgin PTFE 7.0 barg
	R-PTFE 8.5 bar g
최고사용온도(TMO)	200 °C @ 0 bar g
최저사용온도	-29 °C
최고사용차압(ΔPMX)은 PMO로 제한된다.	
수압시험압력	93 bar g

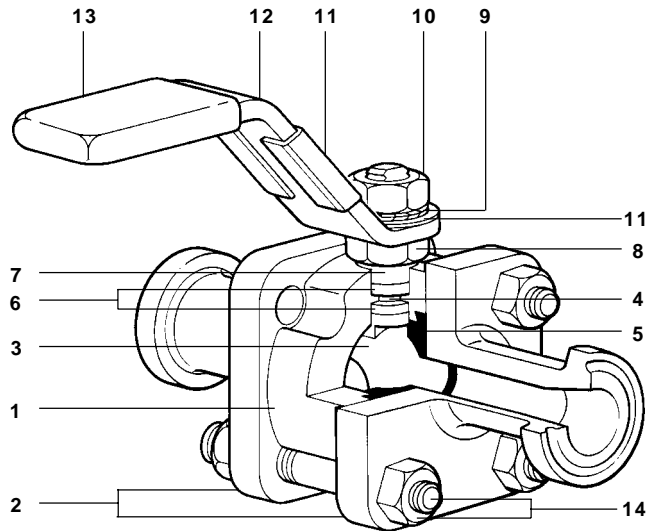

● 재 질

번호	부품명	재질
1	Body	Stainless steel ASTM A 182 F 316L
2	End connections	Stainless steel ASTM A 182 F 316L
3	Ball	Stainless steel AISI 316L
4	Stem	Stainless steel AISI 316L
5	Seat	Reinforced or Virgin PTFE
6	Stem seals	Reinforced PTFE
7	Spacer	Stainless steel AISI 316
8	Compression nut	Stainless steel AISI 316
9	Lock washer	Stainless steel AISI 316
10	Stem nut	Stainless steel AISI 316
11	Name-plates	Stainless steel AISI 430
12	Handle	Stainless steel AISI 316
13	Cover	Vinyl
* 14	Studs and nuts	Stainless steel AISI 316
15	Cavity filler (optional)	Reinforced PTFE

* 항목 15는 다음장에 표시됨

M60 스텐레스강 볼밸브(청정증기용)

● 치수(mm) 및 무게(kg)
트라이-클램프

구경	포트직경						무게
	A4	B	C	D	E	F	
3/8"	89	120	57	22	6.2	44.5	0.45
1/2"	89	120	57	22	8.0	44.5	0.45
3/4"	102	120	63	26	14.0	51.0	0.67
1"	114	157	91	31	21.0	57.0	1.33
1 1/4"	127	157	95	37	25.0	63.5	2.05
1 1/2"	140	180	109	41	31.0	70.0	2.48
2"	159	180	115	48	38.0	79.5	3.50
2 1/2"	192	245	132	57	51.0	96.0	7.25
3"	240	400	177	86	63.0	120.0	19.00
4"	280	400	186	100	75.0	140.0	27.60

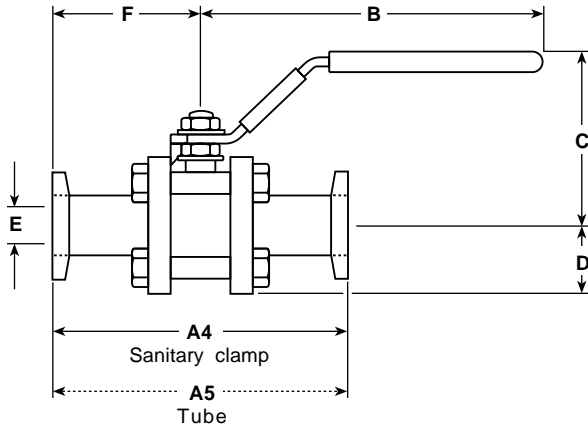

튜브

구경	A5	B	C	D	I/D		F	무게
					E	E		
3/8"	100	120	57	22	6.2	9.5	50.0	0.45
1/2"	100	120	57	22	9.5	12.7	50.0	0.44
3/4"	102	120	63	26	15.9	19.1	51.0	0.66
1"	124	157	91	31	22.2	25.4	62.0	1.25
1 1/4"	127	157	95	37	28.6	31.8	63.5	2.05
1 1/2"	138	180	109	41	34.9	38.1	69.0	2.42
2"	150	180	115	48	47.6	50.8	75.0	3.40
2 1/2"	192	245	132	57	60.2	63.5	96.0	7.25
3"	240	400	177	86	72.8	76.1	120.0	19.00
4"	280	400	186	100	97.6	101.6	140.0	27.60

● Kvs값

DN	3/8"	1/2"	3/4"	1"	1 1/4"	1 1/2"	2"	2 1/2"	3"	4"
Kv	2	2.5	10	27	49	70	103	205	300	580

$C_V(UK) = K_V \times 0.963$ $C_V(US) = K_V \times 1.156$

● 사용토크(N m)

DN	3/8"	1/2"	3/4"	1"	1 1/4"	1 1/2"	2"	2 1/2"	3"	4"
N m	1.9	1.9	3.4	12.9	20	30	39	44	50	70

● 정비방법

● 정비부품
가

정비부품명세	
Seat and stem seal set	5, 6
Seat and stem seal set with cavity filler	5, 6, 15

