



Cert. No. LRQ 0963008

ISO 9001

M10HP 볼밸브 (1/4" ~ 2")

● 응용

M10HP 가 3 , 가 가

● 종류

M10HP2 아연도금 탄소강 몸체, Acetal 시트
M10HP3 스테인레스강 몸체, Acetal 시트

주 : FB는 완전내경(Full Bore), RB는 축소내경(Reduced Bore)

● 구경 및 배관연결방법

1/4", 1/2", 3/4", 1", 1 1/4", 1 1/2", 2"
BSP, BSPT, NPT

* : 2" (RB) 가

● 기술사양

포트	완전 및 축소 내경
누수율	ISO 5208(3 등급)
설계	ANSI B 16.11, B 1.2.1, B 16.34

● 사용조건

최고사용온도	80 °C @ 210 bar g
최고사용압력(MOP)	1/4", 3/8", 1/2" RB 350 bar 1/2" FB; 3/4", 1" RB 315 bar 1" FB; 1 1/4", 1 1/2", 2" RB 280 bar
수압시험압력	1.5 x MOP

● 운전조건범위

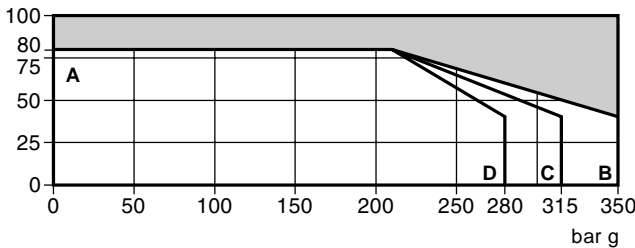

A - B 1/4", 1/2", 3/8" RB
A - C 1/2" FB, 3/4", 1" RB
A - D 1" FB, 1 1/4", 1 1/2", 2" RB

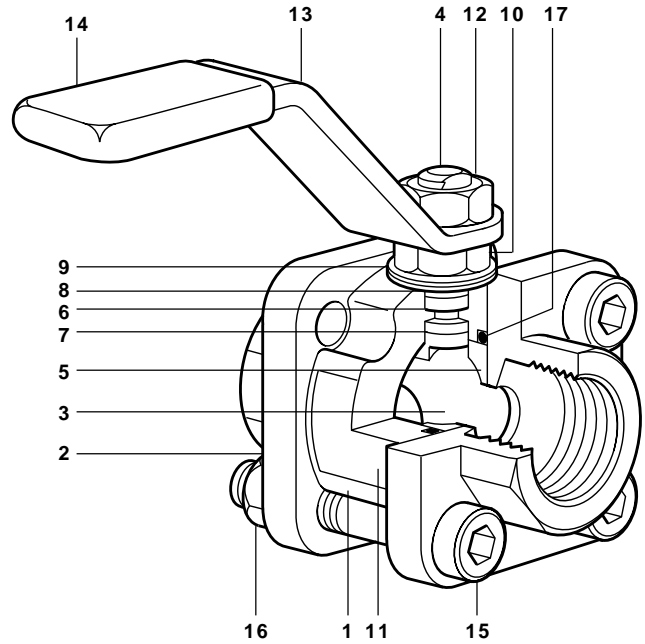

● 재 질

번호	부품명	재질
1	Body	M10HP2 Zinc plated carbon steel ASTM A105
		M10HP3 Stainless steel ASTM A 182 F 316L
2	Cap	M10HP2 Zinc plated carbon steel ASTM A105
		M10HP3 Stainless steel ASTM A 182 F 316L
3	Ball	Stainless steel (Hardened) AISI 316L
4	Stem	Stainless steel AISI 316L
5	Seat	Acetal
6	Stem seal	Antistatic R-PTFE
7	Stem seal	PEEK
8	Separator	Zinc plated carbon steel
9	Belleville washer	Stainless steel AISI 301
10	Nut	Zinc plated carbon steel SAE 12L 14
11	Name-plate	Stainless steel AISI 430
12	Nut	Zinc plated carbon steel SAE 12L 14
13	Lever	Zinc plated carbon steel SAE 1010
14	Grip	Vinyl (Green)
15	Bolts (Allen)	Zinc plated carbon steel Grade 12.9
16	Nuts	Zinc plated carbon steel Grade 2H
17	Cap gasket	Viton 'O' ring

M10HP 볼밸브(1/4" ~ 2")

TI-P133-45
ST Issue 2
(KR 0307)

● 치수(mm) 및 무게(kg)

축소내경

구경	A	A1	B	C	D	E	무게
1/4"	63	60	120	61	24	11	0.61
3/8"	63	63	120	61	24	11	0.61
1/2"	63	52	120	61	24	11	0.61
3/4"	68	60	120	63	26	14	0.70
1"	86	84	157	91	31	21	1.27
1 1/4"	97	94	157	95	37	25	1.77
1 1/2"	106	102	180	109	41	31	2.50
2"	124	118	180	115	48	38	3.50

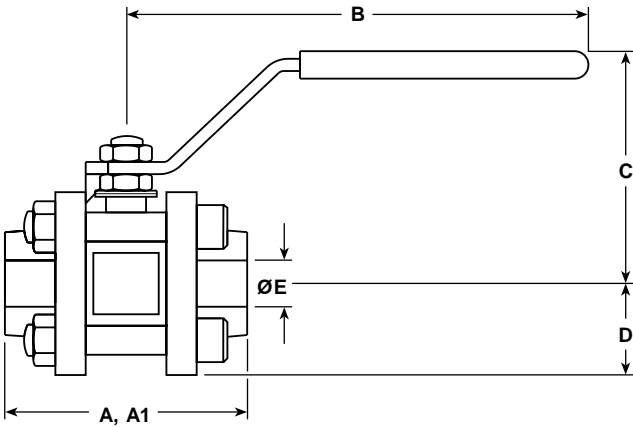

A : 나사식, 버트용접식
A1: 소켓용접식

완전내경

구경	A	A1	B	C	D	E	무게
1/4"	63	60	120	61	24	11	0.61
3/8"	63	63	120	61	24	11	0.61
1/2"	68	68	120	63	26	14	0.70
3/4"	86	86	157	91	31	21	1.27
1"	97	97	157	95	37	25	1.77
1 1/4"	106	106	180	109	41	31	2.50
1 1/2"	124	124	180	115	48	38	3.50

● Kv값

구경	1/4"	3/8"	1/2"	3/4"	1"	1 1/4"	1 1/2"	2"
축소내경	5	6.8	6	10	27	49	70	103
완전내경	5	6.8	17	36	58	89	153	-

$C_v (UK) = K_v \times 0.97$ $C_v (US) = K_v \times 1.17$

● 사용토크(N m)

구경	1/4"	3/8"	1/2"	3/4"	1"	1 1/4"	1 1/2"	2"
축소내경	10	10	10	15	20	40	50	100
완전내경	10	10	15	20	40	50	100	-

75%

● 정비방법

● 정비부품 가

정비부품명세

Seat, stem seals, seat seal set and cap gaskets	5, 6, 7, 17
---	-------------

