



Cert. No. LRQ 0963008

ISO 9001

M10S ISO 볼밸브(1/4" ~ 2 1/2")

● 응용

M10S ISO 가 3

M10S ISO

ISO 부속설비(mounting)

ISO

(seal)

가

가

ISO

● 종류

M10S2 ISO 이연도금 탄소강 몸체, PDR 0.8 시트, ISO 부속설비

M10S3 ISO 스테인레스강 몸체, PDR 0.8 시트, ISO 부속설비

M10S4 ISO 전체 스테인레스강 밸브, PDR 0.8 시트, ISO 부속설비

주 : FB는 완전내경(Full Bore), RB는 축소내경(Reduced Bore)

● 구경 및 배관연결방법

1/4", 1/2", 3/4", 1", 1 1/4", 1 1/2", 2" (2 1/2"

BSP, BSPT, API/NPT, BW, SW

DN15, 20, 25, 40, 50 PN40 ANSI 150/300

● 기술사양

유량특성	변형 선형
포트	완전 및 축소 내경
누수율	ISO 5208(A등급)
정전기방지	ISO 7121 및 BS 5351

● 운전조건범위

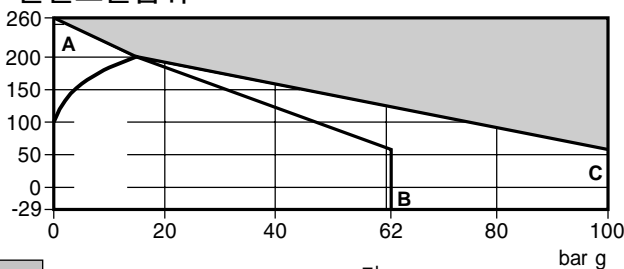

A - B 2" FB 2 1/2" RB

A - C 1/4" ~ 1 1/2" FB, RB 2" RB

주 :

몸체설계조건	PN100
최고허용압력(PMA) @ 60 °C	100 bar g
최고허용온도(TMA) @ 0 bar g	260 °C
최저허용온도	-29 °C
최고사용압력(PMO)	17.5 bar g @ 208.5 °C
최고사용온도(TMO)	260 °C @ 0 bar g
최저사용온도	-29 °C
최고사용차압(ΔPMX)은 PMO로 제한된다.	
수압시험압력	150 bar g

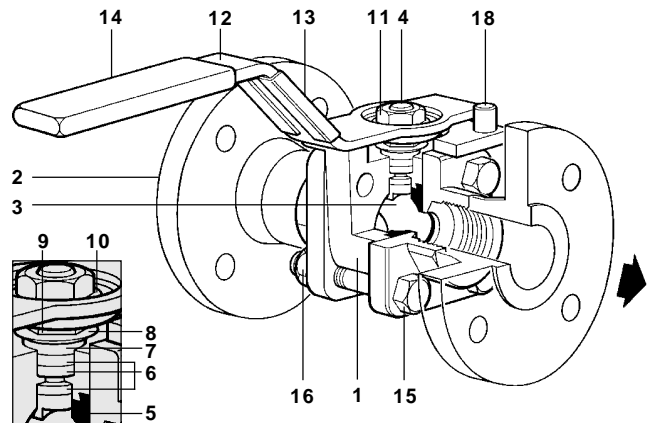

● 재 질

번호부품명	재질
1 Body	M10S2 ISO Zinc plated carbon steel ASTM A105
	M10S3 ISO Stainless steel ASTM A 182 F 316L
	M10S4 ISO Stainless steel ASTM A 182 F 316L
2 Cap	M10S2 ISO Zinc plated carbon steel ASTM A105
	M10S3 ISO Stainless steel ASTM A 182 F 316L
	M10S4 ISO Stainless steel ASTM A 182 F 316L
3 Ball	Stainless steel AISI 316
4 Stem	Stainless steel AISI 316
5 Seat	Carbon/graphite reinforced PTFE PDR 0.8
6 Stem seal	Reinforced PTFE antistatic
7 Separator	M10S2 ISO Zinc plated carbon steel SAE 1010
	M10S3 ISO Stainless steel AISI 316
	M10S4 ISO Stainless steel AISI 316
8 Belleville washer	Stainless steel AISI 301
9 Nut	M10S2 ISO Zinc plated carbon steel SAE 1010
	M10S3 ISO Stainless steel AISI 304
	M10S4 ISO Stainless steel AISI 304
10 Name-plate (DN)	Stainless steel AISI 430
	M10S2 ISO Zinc plated carbon steel SAE 1010
	M10S3 ISO Zinc plated carbon steel SAE 1010
11 Stem nut	M10S4 ISO Stainless steel AISI 304
	M10S2 ISO Zinc plated carbon steel SAE 1010
	M10S3 ISO Zinc plated carbon steel SAE 1010
12 Lever	M10S4 ISO Stainless steel AISI 316
	M10S2 ISO Zinc plated carbon steel SAE 1010
	M10S3 ISO Zinc plated carbon steel SAE 1010
13 Name-plate	Stainless steel AISI 430
	M10S2 ISO Zinc plated carbon steel SAE 1010
	M10S3 ISO Zinc plated carbon steel SAE 1010
14 Grip	Vinyl
15 Bolts	M10S2 ISO Zinc plated carbon steel Grade 5
	M10S3 ISO Stainless steel AISI 304
	M10S4 ISO Stainless steel AISI 304
16 Nuts	M10S2 ISO Zinc plated carbon steel SAE 1010
	M10S3 ISO Zinc plated carbon steel SAE 1010
	M10S4 ISO Stainless steel AISI 304
17 Studs	M10S2 ISO Zinc plated carbon steel SAE 1010
	M10S3 ISO Zinc plated carbon steel SAE 1010
	M10S4 ISO Stainless steel AISI 316
18 Stop screw	M10S2 ISO Zinc plated carbon steel SAE 12L14
	M10S3 ISO Zinc plated carbon steel SAE 12L14
	M10S4 ISO Stainless steel AISI 304

† Note: Item 17 not shown - welded versions only

● 치 수(mm)

축소내경

구경	A	A1	A2	A3	B2	B3	C2	C3	D	D1	D2	E
1/4"	56	52	-	-	130	-	63	-	22	-	-	8
3/8"	56	52	-	-	130	-	63	-	22	-	-	8
1/2"	63	52	108	130	130	145	66	81	24	89	95	11
3/4"	68	60	117	150	130	145	69	84	26	98	105	14
1"	86	84	127	160	162	162	100	100	31	108	115	21
1 1/4"	97	94	140	180	162	162	104	104	37	118	140	25
1 1/2"	106	102	165	200	185	185	112	112	41	127	150	31
2"	124	118	178	230	185	185	120	120	48	152	165	38
2 1/2"	152	152	-	-	250	-	140	140	57	-	-	51

완전내경

구경	A	A1	A2	A3	B2	B3	C2	C3	D	D1	D2	E
1/4"	56	58	-	-	130	-	63	-	22	-	-	8
3/8"	63	60	108	130	130	-	66	81	24	-	-	11
1/2"	68	64	117	150	130	145	69	84	26	-	95	14
3/4"	86	84	127	160	162	162	100	100	31	-	105	21
1"	97	98	140	180	162	162	104	104	37	-	115	25
1 1/4"	106	106	165	200	185	185	112	112	41	-	140	31
1 1/2"	124	124	178	230	185	185	120	120	48	-	150	38
2"	152	152	-	-	250	250	140	140	57	-	165	51

● 무게(, kg)

구경	축소내경			완전내경	
	Scrd/BW/SW	PN40	ANSI 150	Scrd/BW/SW	PN40
1/4"	0.65	-	-	0.65	-
3/8"	0.65	-	-	0.72	-
1/2"	0.72	2.30	1.77	0.95	2.60
3/4"	0.95	3.20	2.35	1.60	3.80
1"	1.60	4.20	3.47	2.05	4.70
1 1/4"	2.05	5.70	4.47	2.75	6.40
1 1/2"	2.75	6.80	5.96	4.25	8.30
2"	4.25	9.50	9.16	7.50	12.80
2 1/2"	7.50	-	-	-	-

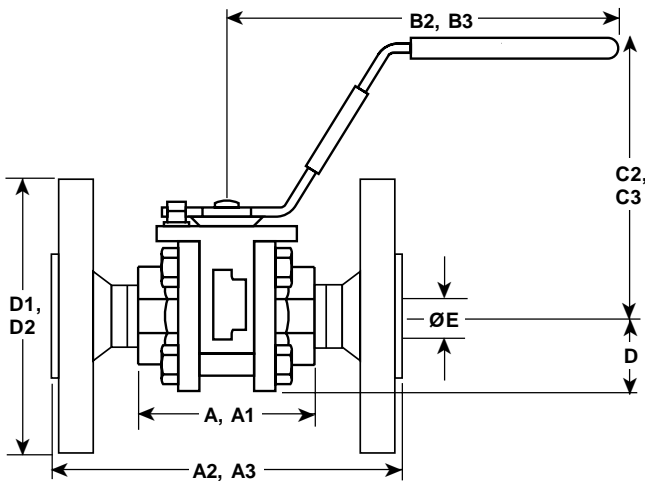

- A : 나사식, 버트용접식
- A1: 소켓용접식
- A2: 플랜지식 ANSI 150
- A3: 플랜지식 PN40
- B2: 나사식, 버트용접식, 소켓용접식
- B3: 플랜지식 PN40, ANSI 150
- C2: 나사식, 버트용접식, 소켓용접식
- C3: 플랜지식 PN40, ANSI 150
- D : 나사식, 버트용접식, 소켓용접식
- D1: 플랜지식 ANSI 150
- D2: 플랜지식 PN40
- E : 모든 배관연결방법

● Kv값

구경	1/4"	3/8"	1/2"	3/4"	1"	1 1/4"	1 1/2"	2"	2 1/2"
축소내경	2.5	2.5	6	10	27	49	70	103	168
완전내경	2.5	6.8	17	36	58	89	153	205	-

$C_v (UK) = K_v \times 0.963$ $C_v (US) = K_v \times 1.156$

● 사용토크(N m)

구경	1/4"	3/8"	1/2"	3/4"	1"	1 1/4"	1 1/2"	2"	2 1/2"
축소내경	2	2	2	3.5	13	21	30	40	45
완전내경	2	2	3.5	13	21	30	40	45	-

40 bar
75 %

● 정비

가 (, SW, BW 가)
가 M10S ISO

● 선택사양

- 가 가 50 mm 100 mm
- 가 ()

● 정비부품

가
정비부품명세
Seat and stem seal set 5, 6

